

<b>Principal Welcome</b>	<b>4</b>
<b>School Vision and Values</b>	<b>5</b>
At VHPS, we have cultivated a school that lies at the heart of the community, filled with joyful learners who are eager to explore the world around them. Our school offers a fun and stimulating learning environment where each day is a magical voyage of discovery for children.	5
We nurture responsible global citizens who are sensitive to other cultures and people. We encourage our students to respect their environment, develop a social conscience, and give back to society.	5
Effective Lifelong Learning Inventory (ELLI)	5
<b>Term Dates</b>	<b>6</b>
<b>Organisation Chart</b>	<b>7</b>
<b>Useful Email Addresses</b>	<b>7</b>
<b>Zenda - School Parent Portal</b>	<b>8</b>
<b>School Mobile Application</b>	<b>9</b>
<b>PayHub360</b>	<b>10</b>
What is PayHub360?	10
Setting up PayHub360	10
<b>Equipment List</b>	<b>11</b>
Chromebook 1:1 Scheme	11
General Equipment/Bags	11
FS1/2	11
KS1/2	11
Stationary	11
All children (Year 1 - 6)	11
In addition to the above, Year 3 & 4 also require	12
In addition to the above, Year 5 & 6 also require	12
<b>School Uniform</b>	<b>13</b>
Girls (FS1 & FS2)	13
Girls (Y1-Y6)	13
Boys (FS1 & FS2)	14
Boys (Y1-Y6)	14
Boys & Girls Swim Kit	15
Important Notes	15
Where to Purchase?	16
<b>School Timings</b>	
<b>The Foundation Stage (VHFS) will open its gates at 7:40 a.m., and the Primary School building (VHPS) will open at 7:30 a.m. Children participating in early morning sports squads can enter from 6:55 a.m. No other earlier admittance will be permitted. We would like to remind parents that children should not be left unsupervised at the school gates prior to the start of the school day.</b>	<b>17</b>

<b>Period 9</b>	<b>17</b>
<b>Pickup and Drop-off</b>	<b>18</b>
VHPS Only	18
Drop-off	19
Pickup	19
VHFS Only	19
Drop-off	20
Pickup	20
Late drop-off/pickup	20
<b>Attendance and Punctuality</b>	<b>21</b>
<b>Fees and Payments</b>	<b>22</b>
Tuition Fee Schedule	22
Refunds	22
<b>Events, Trips and Enrichment</b>	<b>24</b>
Trips	24
Productions	24
Events	24
Payment	24
<b>House System</b>	<b>25</b>
<b>Curriculum</b>	<b>26</b>
Foundation Stage	26
Key Stage 1	26
Key Stage 2	26
Specialist Lessons	26
<b>School Inspection</b>	<b>28</b>
KHDA	28
British Schools Overseas	28
<b>Assessment and Reporting</b>	<b>29</b>
Assessment	29
Mandated (KHDA) Assessments	29
Teacher Assessments	29
Reporting	29
Parent Consultations	29
<b>Feedback and Marking</b>	<b>30</b>
<b>Healthy Eating</b>	<b>31</b>
Ben's Farmhouse	31
<b>Parents</b>	<b>32</b>
Lanyards	32
Communication	32

Expectations of Parent Behaviour

32

Parent Reps

33

## Principal Welcome

Dear Parents,

Welcome to Victory Heights Primary School. As you start your academic year with us, we would like to keep you updated on important information and guidance that will support each family.

At VHPS we are a community rich in diversity, tolerance and values. Through our broad curriculum, and enrichment, we work together to ensure that we become well rounded citizens of the world.

Our mission is to Nurture, to Challenge and Excel and activities. Our unofficial motto is “All you need is love”, about learning, children at Victory Heights Primary School make excellent progress in their time with us, and most children leave having achieved well above national curriculum expectations. Serious about learning invested in happiness!

We look forward to a wonderful year ahead!

Ms Sasha Crabb  
Principal



## School Vision and Values

At VHPS, we have cultivated a school that lies at the heart of the community, filled with joyful learners who are eager to explore the world around them. Our school offers a fun and stimulating learning environment where each day is a magical voyage of discovery for children.

We nurture responsible global citizens who are sensitive to other cultures and people. We encourage our students to respect their environment, develop a social conscience, and give back to society.

### Effective Lifelong Learning Inventory (ELLI)

In keeping with the traditions of the best British schools, we emphasise the importance of a 'well-rounded' education. To achieve this, teachers use the 'Effective Lifelong Learning Inventory' (ELLI), which identifies seven learning dimensions that are key to becoming highly successful lifelong learners.

Each of these dimensions is characterised by an 'ELLI animal', which is outlined below:

The OWL represents planning and strategic awareness.

The CHAMELEON represents the ability to keep changing and learning.

The TORTOISE represents resilience.

The UNICORN represents creativity.

The BEES represent the ability to work alone and in a team.

The CAT represents developing curiosity.

The SPIDER represents making connections and 'webs' of meaning.



## Term Dates

<b>Winter Term</b>	
Meet the Teacher (FS - KS2)	23rd August 2024
First Day of Term 1	26th August 2024
Half Term	21st-25th October 2024
Staff Inset Day (Children in school)	29th November 2024
Commemoration & UAE National Day	1st - 3rd December 2024
End of Term 1	13th December 2024

<b>Spring Term</b>	
First Day of Term 2	6th January 2025
Staff Inset Day (Children in school)	17th January 2025
Half Term	17th-19th February 2025
Ramadan starts (reduced school hours)	27th February 2025 (tbc)
End of Term 2	21st March 2025

<b>Summer Term</b>	
First Day of Term 3	7th April 2025
Arafat Day / Eid-al-Adha	5th-9th June 2025 (tbc)
End of Term 3	27th June 2025

## Organisation Chart

The school is led by an experienced leadership team, headed by Principal Sasha Crabb. Mr. Rothwell, the school's headteacher, oversees the day-to-day operations, including organising timetables, managing pickup and drop-off procedures, and ensuring the safeguarding of all pupils.

Mr. Alex, one of our two assistant headteachers, is responsible for assessment and overseeing Years 2, 4, and 6. Mr. Rob, our second assistant headteacher, focuses on staff professional development and the management of Years 1, 3, and 5. Ms. Sasha Quinn, our Head of EYFS, is in charge of the Foundation Stage, which is based at our VHFS site.

Ms. Michelle, our Inclusion Champion, leads our Inclusion Team, providing support to all children in the school, with particular attention to those requiring additional assistance from our Inclusion team.

### Primary Leadership Team



## Useful Email Addresses

Main School (KS1/2) Reception - [reception@vhprimary.com](mailto:reception@vhprimary.com)

VHFS (FS1/FS2) Reception - [vhfs.reception@vhprimary.com](mailto:vhfs.reception@vhprimary.com)

Accounts Department - [accounts@vhprimary.com](mailto:accounts@vhprimary.com)

Admissions - [admissions@vhprimary.com](mailto:admissions@vhprimary.com)

School Clinic - [doctor@vhprimary.com](mailto:doctor@vhprimary.com)

VHFS Clinic - [clinic@vhprimary.com](mailto:clinic@vhprimary.com)

Parent Liaison (Emma) - [parentliaison@vhprimary.com](mailto:parentliaison@vhprimary.com)

Transport (Buses) - [facilities-site@vhprimary.com](mailto:facilities-site@vhprimary.com)

## Zenda - School Parent Portal

Zenda is our school parent portal, which enables parents to access a range of important information relating to their child and the school as a whole, including:

- Whole school communications (e.g. weekly newsletters, important announcements)
- Your child's report cards
- Absence/leave requests
- Your child's details including health information
- Your child's academic timetable
- Clinic visit information

To download Zenda, please visit Google Play or the Apple App Store and search for 'Zenda'

Firstly, please enter the school code: **vhps**

Use your school registered mobile or email address to sign up

If you are encountering any difficulties in signing up, our IT department will be happy to assist, please email at [it@vhprimary.com](mailto:it@vhprimary.com) stating your child's class, full name, your registered email address and mobile number.

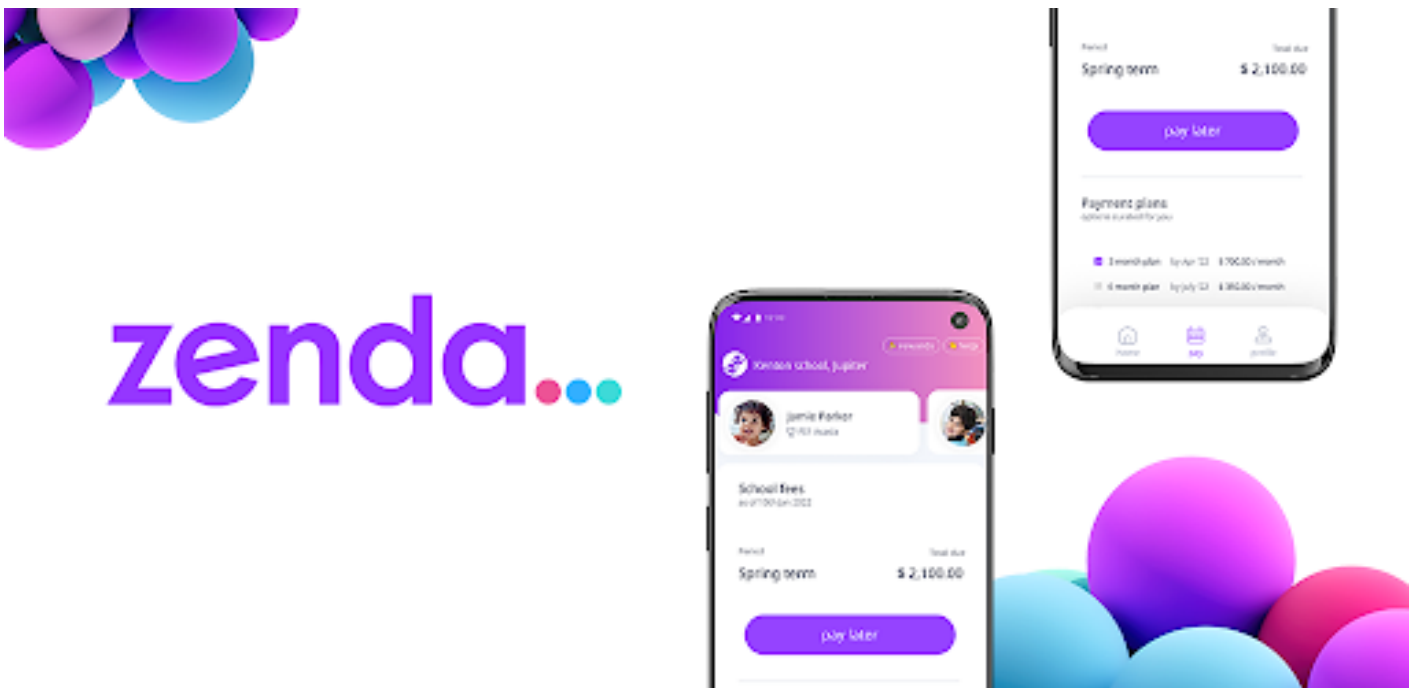



## School Mobile Application

School news is regularly published through our school mobile application, which is available at <http://mobile.vhprimary.com>

It is very important to check this app regularly!

This is available as a web application which will work on all major smartphones and Tablets.

You will need to open the website (<http://mobile.vhprimary.com>) in your mobile's browser and click "Add to Home Screen" – a VHPS icon will now be on your smartphone home page. Alternatively, you can choose this option from the 'Bookmarks' or 'Favourites' section of your browser.

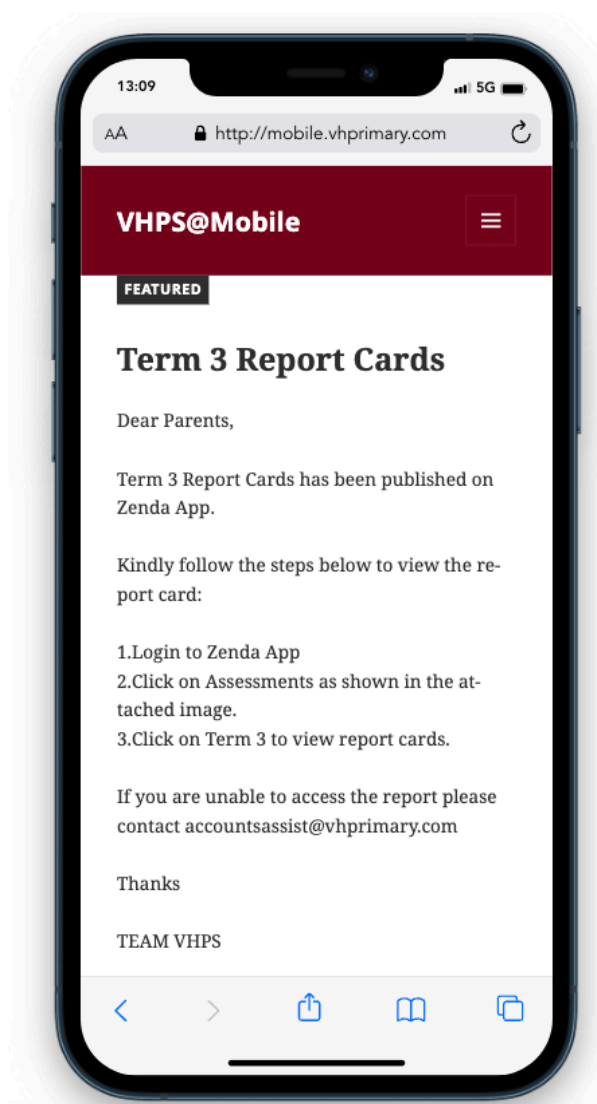

# PayHub360

## What is PayHub360?

At Victory Heights Primary School we are committed to bringing the best adventures to you.

Now you can pay for all school fees, trips and events quickly and easily.

## Setting up PayHub360

Visit: <https://payhub360.com>

Log in using your registered email address with the school.

Enter the default password: **school**

Click on 'Student Profile.'

Select 'Activity Fee/Term Fee' and click on 'Add to Cart.'

Select 'Meal Preferences' or 'Options,' if applicable, and add your signature to confirm consent for the activity.

Click on 'Proceed' to payment.

Enter your card details and click on 'Pay Now.'

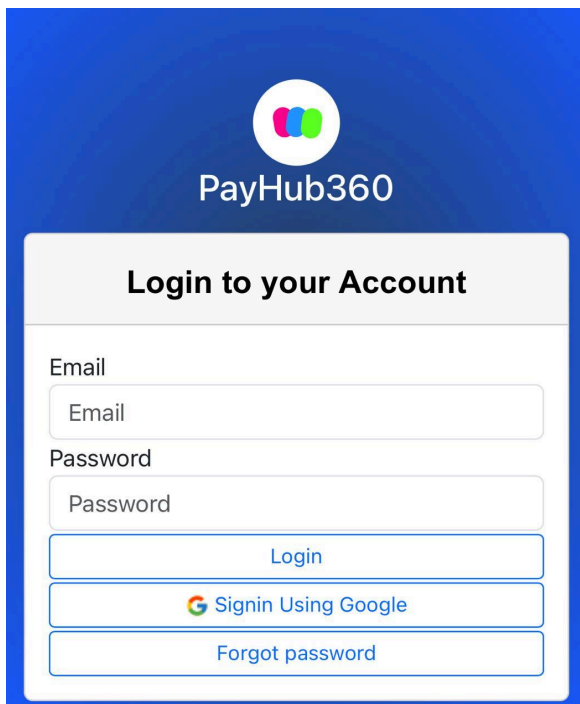

The image shows a screenshot of the PayHub360 login interface. At the top, there is a blue header with the PayHub360 logo (a circle containing three colored dots) and the text 'PayHub360'. Below the header is a white box with a grey title bar that says 'Login to your Account'. Inside this box, there are two input fields: one for 'Email' and one for 'Password'. Below the input fields are three buttons: a blue 'Login' button, a blue button with the Google logo and the text 'Signin Using Google', and a blue button with the text 'Forgot password'.

# Equipment List

## Chromebook 1:1 Scheme

All children from Years 2 - 6 are required to have a Chromebook. A Chromebook is a portable laptop computer that runs ChromeOS.

Device Specification: Acer Chromebook Spin 512 is a 12" Chromebook with 8GB memory, 64GB flash storage and a FHD screen.

**All devices must be enrolled on the school's management console, which incurs a one time cost of 250 aed for devices.**

We recommend that all devices are brought to school in a suitable laptop case.

## General Equipment/Bags

### *FS1/2*

Book Bag

Small rucksack\* (with change of clothes)

Drawstring swimming bag

Lunch box/bag (if bringing packed lunch)

Reusable water bottle

### *KS1/2*

Book bag

Small rucksack\*

Drawstring swimming bag

Lunch box/bag (if bringing packed lunch)

Reusable water bottle

\*Please note: 'Trolley' bags (with wheels, pull handle) are not appropriate for school and are not permitted.

## Stationary

### *All children (Year 1 - 6)*

A pencil case

HB Pencils, sharpener and eraser

30cm ruler

Colouring pencils  
Glue stick  
White board Marker(s)/Eraser  
Child friendly scissors

*In addition to the above, Year 3 & 4 also require*

Purple 'Pilot Frixion' Pen(s)

*In addition to the above, Year 5 & 6 also require*

Purple 'Pilot Frixion' Pen(s)

Black 'Pilot Frixion' Pen(s)

Protractor

It is important to note that consumable items (pens, pencils, glue stick, whiteboard markers) should be replenished on a regular basis. We recommend purchasing multi-packs and keeping a supply at home, replenishing as and when needed.

## School Uniform

At Victory Heights Primary School all children are expected to wear the full uniform at all times. Please see the below diagram regarding the compulsory items.

### Girls (FS1 & FS2)

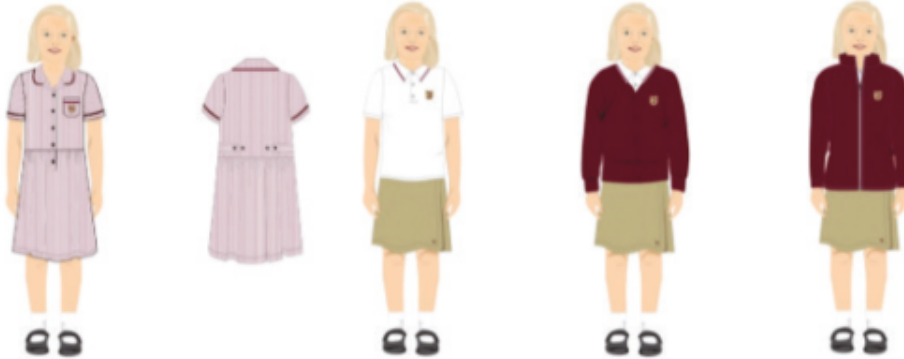

- VH Dress in 'White and Maroon' Stripes
- Skort in 'Stone'
- Polo Shirt with 'Maroon' Stripes
- V-neck Cardigan in 'Maroon' Stripes
- Fleece Jacket in 'Maroon' (Optional)
- Wide Brimmed Hat (Not pictured)
- White Socks and Black Shoes (Velcro or Laces) FS1
- FS1&FS2 must keep a spare uniform in their bag

### Girls (Y1-Y6)



- VH Dress in 'White and Maroon' Stripes (Y1 & 2)
- Skort in 'Stone'
- VH Short Sleeve blouse in white + maroon stripes
- V-neck Cardigan in 'Maroon' Stripes

- Fleece Jacket in 'Maroon' (Optional)
- Wide Brimmed Hat (Not pictured, Years 1-2)
- Baseball Hat (Not pictured, Years 3-6)
- White Socks and Black Shoes (Velcro or Laces)

### Boys (FS1 & FS2)



- Short in 'Stone'
- Polo Shirt with 'Maroon' Stripes
- V-neck jumper in Maroon(optional)
- Fleece jacket in Maroon (optional)
- Wide Brimmed Hat (not pictured)
- Navy socks and Black Shoes
- FS1 & FS2 must keep a spare uniform in their bag

### Boys (Y1-Y6)



- Short in 'Stone'
- VH Short sleeve shirt in White and Maroon
- V-neck jumper in Maroon(optional)
- Fleece jacket in Maroon (optional)
- Wide Brimmed Hat (not pictured ,Year 1&2)

- Basketball Hat (Not pictured, Years 3-6)
- Navy socks and Black Shoes

## Boys & Girls Swim Kit



- Polo Top in Maroon / White
- Shorts in White and Maroon
- White or Black Trainers (No coloured adornments)
- VH Swimming Costume
- VH Swim Cap (Not Pictured)
- Towel (of your choice)

## Important Notes

- Girl's hair must be tied back at all times for safety reasons.
- Jewellery - Students may wear a single plain stud earring in each ear. No hoops or dangling earrings are allowed. A watch may be worn however, no other jewellery is allowed in school including necklaces, bracelets or rings unless requested by parents for religious purposes. All requests must be approved by the Principal.
- No make-up or nail varnish is allowed
- Children may choose their own backpack. However, No Wheelie bags are allowed in school.
- No coloured trainers.

**No 'Smart' watches are permitted in school, with no exceptions.**

## Where to Purchase?

VHPS uniforms can be purchased online or by visiting the shop. Further direction on this information is provided below.



VICTORY HEIGHTS  
PRIMARY SCHOOL  
NURTURE • CHALLENGE • EXCEL

## UNIFORM GUIDE



### ORDER ONLINE AT

[www.shopatsumeru.com](http://www.shopatsumeru.com)

- Visit our website
- New user kindly REGISTER and existing users kindly LOGIN
- Search your school bar: Please enter first school name
- Check garment size for each item
- Proceed to checkout and payment



Location:  
J3 Mall, Level 1, 983, Al  
Wasl Road, Umm  
Suqeim



Timing:  
Monday to Saturday  
10am to 7:30pm



Contact:  
+971 58 102 9932  
+971 58 945 2403



Online Sales:  
[www.shopatsumeru.com](http://www.shopatsumeru.com)  
Merchandise will be delivered to  
your residence via courier



Additional Services:

- Made to measure at retail location
- Alteration available at retail location
- Iron on name tags available



## School Timings

The Foundation Stage (VHFS) will open its gates at 7:40 a.m., and the Primary School building (VHPS) will open at 7:30 a.m. Children participating in early morning sports squads can enter from 6:55 a.m. No other earlier admittance will be permitted. We would like to remind parents that children should not be left unsupervised at the school gates prior to the start of the school day.

Monday - Thursday	FS1	7.40-8.00	13.15-13.30
	FS2	8.00-8.20	13.45-14.00
	Year 1-2	7.30-7.55	15.00-15.10
	Year 3-6	7.30-7.55	15.00-15.10
Friday	FS1	7.40-8.00	11.00-11.15
	FS2	8.00-8.20	11.15-11.30
	Year 1-2	7.30-7.55	11.30-11.40
	Year 3-6	7.30-7.55	11.40-11.50

*The recent adjustment to school timings for the academic year 2024/25 has increased academic time by 130 minutes per week for KS2 and 170 minutes per week for KS1*

## Period 9

The school offers an extracurricular program available at no cost to all children from Years 1-6\*. This program includes a variety of extra- and co-curricular activities, selected by the children and organised on a carousel basis by our academic staff. The program is designed to help students explore interests in areas such as sports, technology, and academics, culminating in showcase moments. Additionally, longer-term activities, such as the school choir and performing arts, are also part of the extended day program.

A full list of Period 9 activities will be provided early in the academic year.

## After School Enrichment

We are delighted to offer a paid aftercare provision at both our Foundation Stage building and Primary School. Our after-school enrichment activities are led by members of our academic team, providing a seamless extension of the school day. In the Foundation Stage, the after-school sessions are play-based, designed to support young children's development in a relaxed environment. For our Primary School students, the After-School Enrichment program offers a wide range of curriculum-linked activities, including reading, handwriting, mental math, and art. All children attending the after-school club will receive a complimentary snack and drink provided by our catering partner, Ben's Farmhouse.

Monday - Thursday	FS1	13.30-14.45
	FS2	14.00-14.45
	Year 1-6 (Option 1)	15.00-15.45
	Year 3-6 (Option 2)	15.00-16.30
Friday	Year 1-6	12.00-13.30

Aftercare is available on a personalised basis, allowing parents to select days and times based on their preferences. Please note, Ad hoc care is also available, where you can sign up your child on the day, before 12 p.m.

You can express and confirm interest via the sign up link.

[https://docs.google.com/forms/d/e/1FAIpQLScwyAjqrJbIC223f-0FndVM\\_0NosN1D9jSX0pdJEVOnnyvzkQ/viewform](https://docs.google.com/forms/d/e/1FAIpQLScwyAjqrJbIC223f-0FndVM_0NosN1D9jSX0pdJEVOnnyvzkQ/viewform)

## Pickup and Drop-off

### VHPS Only

The main school building operates a curbside drop-off system in the mornings to help ease traffic flow in the local area. Members of the school's academic team are on hand to assist children in safely exiting vehicles and entering the school.

To ensure that traffic is evenly distributed across the two curbside drop-off zones, we ask that you follow the designated drop-off locations shown below. If you have children in multiple year groups, please drop all children at the location designated for the **youngest sibling**. There is no need to make multiple stops.

Drop-off is available from 7:30 to 7:55 am. If you arrive after this time, you must park and accompany your child to reception for late registration.

There is no entry to the school site in the morning for parents.\*

***Drop-off***

Canal Residences Side Gate 2	Years 1-2
Els Club Side Gate 4	Years 3-6

\* Year 1 parents are permitted on site until the first half term.

***Pickup***

Parents must collect their children in the afternoon from the collection points shown below. **Please be prompt to collect your child.** If you arrive after the collection time has finished, your child will be taken to the main school reception. If there are multiple instances of late collection, you will be invited to a meeting with a member of the school's leadership team.

FS Classrooms	FS1 13.15 - 13.30   Fridays 11.00 - 11.15 FS2 13.45 - 14.00   Fridays 11.15 - 11.30
Canal Residences Side Enter Gate 2 - Pickup from Year 1 classrooms	Years 1 and 2 15.00-15.10   Fridays 11.30-11.40
Els Club Side Enter Gate 4 - Pickup from MPH	Years 3, 4 and 6 15.00-15.10   Fridays 11.40-11.50
Arabic Block Enter Gate 6	Year 5 15.00-15.10   Fridays 11.40 - 11.50

***VHFS Only***

The VHFS building operates in an area with limited parking due to residential and commercial developments. With this in mind, we operate a staggered drop-off and pickup, and request parents to adhere to these timings.

We also promote the use of car-sharing where possible, or walking/cycling to school from the adjacent communities.

Please also be mindful of the limited parking, and once you have collected/dropped off your child, please leave the area quickly, so as to free up parking for other parents.

### ***Drop-off***

Please take your child directly to their class using the outside doors. You will be greeted by the class teacher or the classroom assistant.

### ***Pickup***

You can collect your child from the classroom at the end of the school day.

### ***Late drop-off/pickup***

If you are late to drop-off or collect your child, then please proceed to the VHFS Reception. It is important to ensure your child's punctuality, and to collect them on time. If there are any concerns with this, the Head of EYFS will ask to meet you in person to discuss how to improve your punctuality.

## Attendance and Punctuality

Victory Heights Primary School promotes high levels of attendance and punctuality across the school. There is a clear connection supported by research, between high levels of attendance and achievement.

Students are expected to attend school every day unless they are ill. Family holidays should be organised in school holiday time. Requests for time out of school for family occasions can be granted at the Principals' discretion. If a student is absent, a request must be logged on the Zenda app.

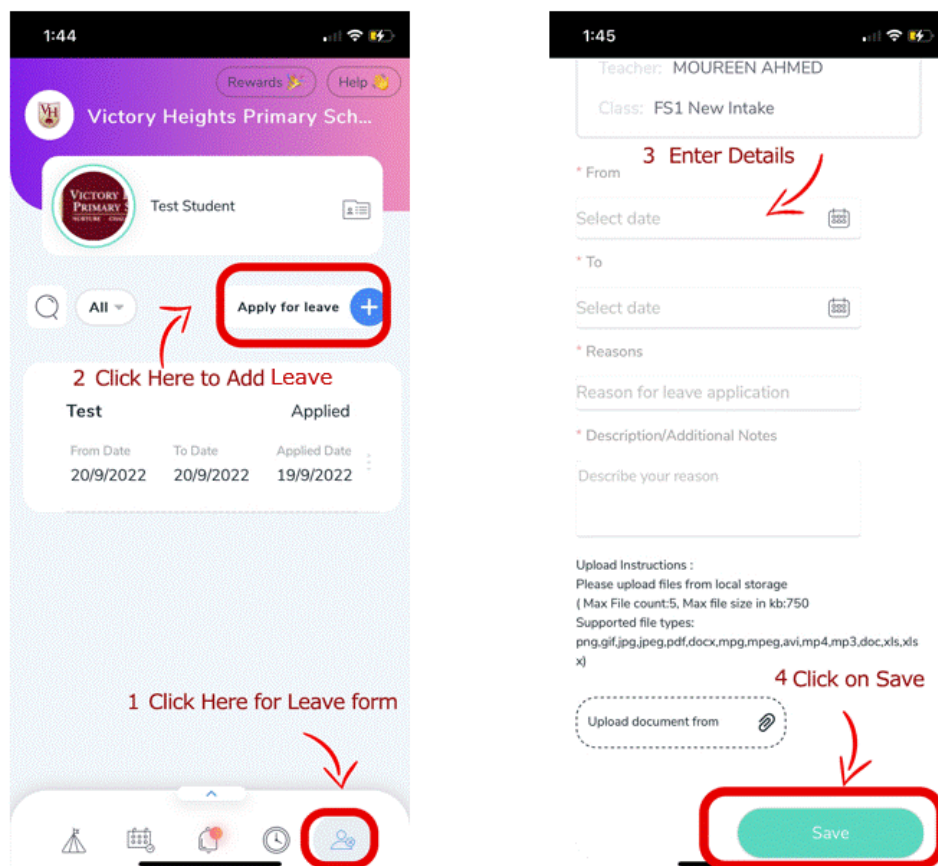

Students are expected to be in class before the National Anthem which is played at 8.00 am. Students arriving after the National Anthem are recorded as late. Persistent lateness will be addressed with the parent and escalated to PLT if the lateness continues.

## Fees and Payments

Tuition fees at Victory Heights Primary School (“VH Primary”) are as per the Tuition Fee Schedule set out below:

### Tuition Fee Schedule

Year Group	Term 1	Term 2	Term 3	Total
FS1	15,686	11,765	11,765	39,216
FS2	17,112	12,834	12,834	42,780
Year 1	18,538	13,904	13,904	46,346
Year 2	18,538	13,904	13,904	46,346
Year 3	19,965	14,973	14,973	49,911
Year 4	19,965	14,973	14,973	49,911
Year 5	21,390	16,043	16,043	53,476
Year 6	21,390	16,043	16,043	53,476
Due Date	26th August 2024	6th January 2025	7th April 2025	

Please note that the above Tuition Fees are exclusive of transport, school uniforms, food services, and any English language or Special Needs Learning Support that students may require. Tuition fees also do not include the cost of field trips, additional after-school/extra-curricular activities/clubs or holiday camps, all of which shall be charged separately.

### Refunds

The Application Fee, Enrolment Fee and Re-Enrolment Fee are all non-refundable, in accordance with KHDA guidelines which states that, in the case of both existing and new students, schools are not required to refund deposits and fees if students choose not to return to school for the next academic year or choose not to take the offered places.

Whilst the above fees are non-refundable, tuition fee refunds follow the Ministry of Education Bilo of Federal Law No. (28) for Private Education. If a student withdraws or leaves school for any reason, and has given one full term’s written notice, asset out above, refunds will be made to the original payee as set out below:

1. If a student withdraws prior to the start of the academic year, the balance of the first term's fees paid will be refunded, except for the Application Fee and Enrolment Fee.
2. If a student withdraws during the school year, the Application Fee and Enrolment Fee are non-refundable and the remaining tuition fee is calculated as follows:
  - a. If a student attends school for two weeks or less, one full month's fee will be charged;
  - b. If a student attends school for more than two weeks, but less than one month, two full month's fees will be charged; and
  - c. If a student attends school for more than one month, the entire term's fees will be charged.

The value of the fee per month is calculated by dividing the total tuition fees by ten. Charges for books and school uniforms will not be refunded, but the above conditions for refund apply to bus fees for transportation provided by the school.

There are no fee refunds in any other circumstances except those stated above.

All other Fee Payment information can be found in our Fee Payment Policy, which can be found at

<https://www.vhprimary.com/userfiles/vhdmvc/2024%20tuition%20fee%20UPDATED1.pdf>

## **Events, Trips and Enrichment**

### **Trips**

As part of our commitment to ensuring that children at Victory Heights Primary School are afforded access to a broad, balanced and culturally enriching curriculum, we organise a number of trips throughout the course of the year.

Our commitment is to ensure that parents will pay no more than 750 aed\* per year on events and trips, excluding residential trips.

\*Children who study Islamic Studies may incur some small, additional costs to support Islamic Studies curriculum visits.

### **Productions**

We have been inviting visiting theatrical companies to perform to our children since the school opened, and consider the experience to be extremely valuable and engaging for the children.

These productions are high quality, with professional actors, and attract a ticket cost. We primarily work with Shakespeare 4 Kids (S4K) and Dune Productions, and we look forward to inviting them into school again this year.

### **Events**

We host a number of special events throughout the year, that usually coincide with non uniform days. These celebrate events such as UAE National Day, International Day of Peace and World Book Day. These events will be shared with you ahead of time so that you can plan for non-uniform days.

### **Payment**

Full details of your child's year group trips and events will be shared with you at the beginning of the academic year. These can be paid for using the PayHub360

Payment for trips and events will close one week before the date of the trip, and after this point no additional payments will be taken.



## House System

Our school has four houses, each named after an animal native to the Arabian Peninsula: Oryx (green), Foxes (red), Leopards (yellow), and Falcons (blue). All children from FS2 to Year 6 are assigned to a house.

The house system fosters a strong community spirit, enhances a child's sense of belonging, and celebrates achievements outside the classroom through special house days, social and sporting events, and various competitions.

House Captains, chosen for being exemplary role models, have a range of responsibilities, including leading teams, organising events, and collecting and verifying house point totals.

House points are awarded by all teachers for effort, achievement, good behaviour, and sportsmanship. Our house events and competitions are aligned with the school's vision, values, and our ELLI animals.

Throughout the year, we host numerous events and competitions in which all students have the opportunity to participate. These include projects on global and UAE issues such as sustainability.

In addition, we hold inter-school sports competitions, like our Great VHPS Bake Off and House Sports Week. All events contribute to house points, and students are encouraged to participate actively.

Children are required to wear their house shirts on any calendared house days and are also invited to wear them on their designated swimming days. House shirts are available through the school uniform supplier, as mentioned above.



# Curriculum

Victory Heights Primary School follows the British School system, based on the National Curriculum for England. We work in partnership with the BSME (British Schools for the Middle East) to ensure that we are always in line with the latest educational developments being implemented in the UK.

VHPS is divided into three Key Stages, guiding your children's educational journey.

## Foundation Stage

Starting from age three, FS1 and FS2 follow the Early Years Framework. At the end of the Foundation Stage the children will be assessed using this framework on the 'Early Learning Goals'. Play and exploration remains an important part of the curriculum, alongside more focused activities, including our phonics programme. All the knowledge, skills and understanding are taught in a holistic manner through interesting topics, created from the children's interests and imagination. Arabic is introduced to both native and non-native learners from FS2.

## Key Stage 1

Starting from age five, Year 1 and 2 will build upon their foundation framework and continue to explore the world around them, with an increased emphasis on developing skills and understanding of a wide range of core subjects. Links are made across the curriculum wherever possible, in keeping with our holistic teaching methodology. This recognises that the learning experience is greatly enriched when subjects are not taught in isolation.

## Key Stage 2

Starting from age seven, covering Year 3 to 6. In Year 3 our foreign language program will introduce Spanish to our students. We have Curriculum Leaders to ensure that there is a natural progression from children moving from one year group to the next. After graduating from Year 6, students are extremely well-prepared for the challenges of secondary school!

We are delighted that this past year all of our Year 6 students received placements in one of their first choice of high schools!

## Specialist Lessons

In addition to the class teacher (who will teach the class English, Math, Science, Humanities and Moral, Social and Cultural Studies), we have specialist teachers that deliver lessons across the key stages in:

- Art (from Year 1)
- Music
- Physical Education & Swimming \*
- Spanish (KS2 only)
- Arabic (from FS2)
- Islamic Studies (from Year 2)
- Computing (from Year 1)
- SPARK - an exciting and innovative class to 'spark the imagination' of Year 1 children
- STEAM (Science, Technology, Engineering, Arts & Maths) STEAM is for Years 2-6 which brings all of these subjects together in exciting experiments and investigations.

\* Swimming begins after October half term for FS2, and at the beginning of Term 2 for FS1

# School Inspection

## KHDA

The Knowledge and Human Development Authority (KHDA) is responsible for overseeing the growth and quality of private education in Dubai. KHDA accredited Victory Heights with an "Outstanding" rating in 2022-23, and in the most recent inspection, we proudly maintained this rating and were also awarded "Outstanding" in Well-being. We were ranked Outstanding in Well-being and Inclusion, a distinction achieved by only 10 other schools within the Emirate of Dubai.

Victory Heights excels in all areas of English, Maths, and Science, as well as in personal development, teaching, curriculum, assessment, leadership and management, and Well-being. In Arabic language subjects, we are a rapidly improving school, showing successful progress in Arabic A, Arabic B, and Islamic Studies. We are proud of the hard work our teachers and families have invested in the continued development of the school, and we are excited for the upcoming year!

You can view the full report on our website under 'Inspection Reports.'

## British Schools Overseas

Additionally, as a "British Schools Overseas", we are inspected on a regular basis by BSO, with inspections carried out by the Education Development Trust. In 2021/22, we were adjudged to be "**Outstanding**" in all areas.

We look forward to another BSO inspection in 2025.

You can view the full report on our website under '[Inspection Reports](#)'

# Assessment and Reporting

## Assessment

Children at Victory Heights Primary School are continuously assessed to ensure that they are making progress in lessons.

The vast majority of assessment can be characterised as 'formative assessment' - that is, the assessment of a child's progress that takes place within a lesson, and is designed to support the child in ascertaining the next steps in learning required.

Children are also summatively assessed. These assessments are far less frequent, and give a judgement of a child's attainment (achievement) over a greater period of time. These summative assessments include:

### *Mandated (KHDA) Assessments*

- GL Progress Tests (Reading, Maths, Science) - End of academic year
- New Group Reading Test (Reading) - 3 times per academic year
- Cognitive Ability Test (CAT4) - Beginning of academic year

### *Teacher Assessments*

- End of term attainment grade (all subjects) - teacher assessment
- Islamic Studies end of year assessment (for Muslim children only)
- Arabic end of year assessment

## Reporting

You will receive two academic reports per year. The first will be shared in December, which will report on your child's attainment in the first term. This will be accompanied by an opportunity to visit your child's classroom and to view their books, alongside the teacher.

The second report, which is in greater depth, is received at the end of the academic year. This reports on your child's attainment for the entire academic year.

## Parent Consultations

Throughout the year, you will have the opportunity to meet with your class teacher to discuss your child's achievements.

- Parent Consultation 1 - week beginning 14th October
- Parent Open Classroom 1 (Y1-3) - week beginning 4th December\*

- Parent Open Classroom 1 (Y4-6) - week beginning 9th December
- Parent Consultation 2 - week beginning 3rd February
- Parent Open Classroom 2 - week beginning 19th May

*\*Due to National Day*

## **Feedback and Marking**

There is no 'prescribed' method of marking/feedback at Victory Heights Primary School. We recognise that different subjects and contexts call for different methodologies. Given the excess workload demands that written marking places on teaching staff, which can be to the detriment of teacher wellbeing, coupled with the lack of evidence that written marking has any significant level of impact on children's achievement, Victory Heights Primary School suggests these alternative feedback strategies (in no particular order).

Whole Class Feedback

Verbal Feedback

'Live' Marking

Peer and Self Assessment

Use of multiple choice questions (MCQs) - preferably electronically marked

Use of 'Comparative Judgement' to assess and moderate written work

Dialogue, questioning and use of formative assessment (characterised as AfL)

Digital audio feedback (through platforms such as Seesaw and Flipgrid)

Our Feedback and Marking policy has been subject to rigorous internal review, and has been externally praised by DSIB inspectors.

Therefore, you should not expect that your child's books will be full of ticks acknowledging work, or teacher comments. The progress that you will observe in your child's book, over an extended period of time, should tell its own story that your child has received feedback that has enabled them to develop.

## Healthy Eating



A balanced diet is important for good health, and it is recognised that there is an important connection between a healthy diet and a pupil's ability to learn effectively.

We aim to provide an environment that supports a positive healthy approach to eating practices. Where children are provided with a packed lunch, parents are advised to ensure that snacks and lunches contain sufficient nutrition to satisfy the child. It should contain a source of protein to keep the child alert. It should contain a source of carbohydrates to sustain the child's energy levels. It should contain a source of calcium for growth and healthy bones.

### **Ben's Farmhouse**

We are delighted to partner with Ben's Farmhouse, a farm to table, homegrown concept, that provides delicious and healthy snacks and lunches to children across the school, FS1 - Year 6.

Further information about our weekly menu is published on our mobile website, along with the opportunity to order meals in advance.

## **Parents**

### **Lanyards**

For students' safety and verification of adults on school grounds, it is essential that all parents wear their parent lanyard every time they are on the school premises, so please make sure to submit your picture to school reception who will issue the ID for you. Your lanyard(s) will be available at the meet and greet session in the first week of term.

Two guardian IDs are complimentary. There is an AED 50 charge for replacing lost IDs, as well as for any additional ID's required for other authorised caregivers.

Please ensure you have emailed a passport-sized headshot photo of both guardians and child to [admissions@vhprimary.com](mailto:admissions@vhprimary.com) as soon as possible, to ensure your movement is not impacted on school premises.

### **Communication**

Victory Heights Primary School recognises that communication between parents and school is essential to ensuring the success of children.

Your child's class teacher will use Seesaw as the primary method of communication with you. Please be mindful that teachers are busy with their class throughout the school day, and are not available to immediately reply. Our expectation is that you will receive a reply within 24 hours of your first communication.

If you have a more urgent and pressing concern, please contact our school reception at 04 423 1100.

Whilst we value our good relations with parents, please be respectful of your child's class teacher's time and limit communications to essential matters only.

### **Expectations of Parent Behaviour**

All staff at Victory Heights Primary School engage with parents in a polite and respectful manner. At no time should any member of the school staff feel threatened or intimidated, or be spoken to rudely by a member of the school community.



The school will not tolerate anti-social behaviour of this kind, and parents will be invited to meet with the Principal in the first instance, and further recurring behaviour may result in us taking further action, including removal of access to the school site.

## **Parent Reps**

We value the contribution of our parents who volunteer their time to become class representatives, and we know that other parents find this invaluable as well

Class parent reps help us in disseminating information about school events to parents, usually through channels such as Whatsapp. They are often able to quickly answer short questions that parents may have, such as “Is tomorrow a non-uniform day?”

Whilst class reps are invaluable, we do recognise that they have their own day to day lives to attend to, and we ask that other parents be mindful of this. We also ask that for non-trivial questions, parents direct their questions to the school, to ensure that they have received the correct information.

If you are interested in becoming a class rep, please email [parentliaison@vhprimary.com](mailto:parentliaison@vhprimary.com) to register your interest.